

**TECHNICAL SPECIFICATIONS**

- Height:	427 mm	- Temperature after brewing:	85 ± 3 °C
- Breath:	200 mm	- Temperature after 30 minutes:	82 ± 3 °C
- Depth:	378 mm	- Temperature after 60 minutes:	80 ± 3 °C
- Voltage:	220-240 V~	- Minimum brew volume:	6 cups / 0.9 l
- Frequency:	50 Hz	- Maximum volume per brew:	12 cups / 1.8 l
- Total power:	2075 W	- Brewing time per jug:	5 min
- Power of boiler:	2000 W	- Capacity per hour:	134 cups / 20 l
- Power of PTC-element:	variable	- Water filling:	manual
- Number of hotplates:	1		

**GENERAL**

- The appliance must only be connected to an earthed plug socket.
- The appliance must never be submerged in water or rinsed under the tap.
- The appliance is fitted with a descaling warning system (red pilot light).
- The appliance is fitted with two temperature safeguards that can be reset.
- For this appliance use finely ground coffee and filter paper type 90/250.

**INSTRUCTIONS FOR USE**

- Place the filter paper and coffee in the filter basket (approx. 6 grams for each cup of 125 cc),
- Slide the filter basket back into the appliance,
- Place the glass jug on the hotplate,
- Fill the appliance with water equal to the amount of coffee to be made,
- Switch on the appliance (the light in the switch and the orange pilot light should now illuminate),
- Wait until the orange pilot light goes out,
- The coffee is ready and will be kept warm.

**MAINTENANCE**

- Wipe the outside of the appliance using a damp soft cloth, preferably with a soap-based cleaning agent (do not use a scouring agent!).
- Clean the filter basket and glass jug with washing-up liquid.
- The appliance must be descaled regularly (follow the instructions for the descaling agent).

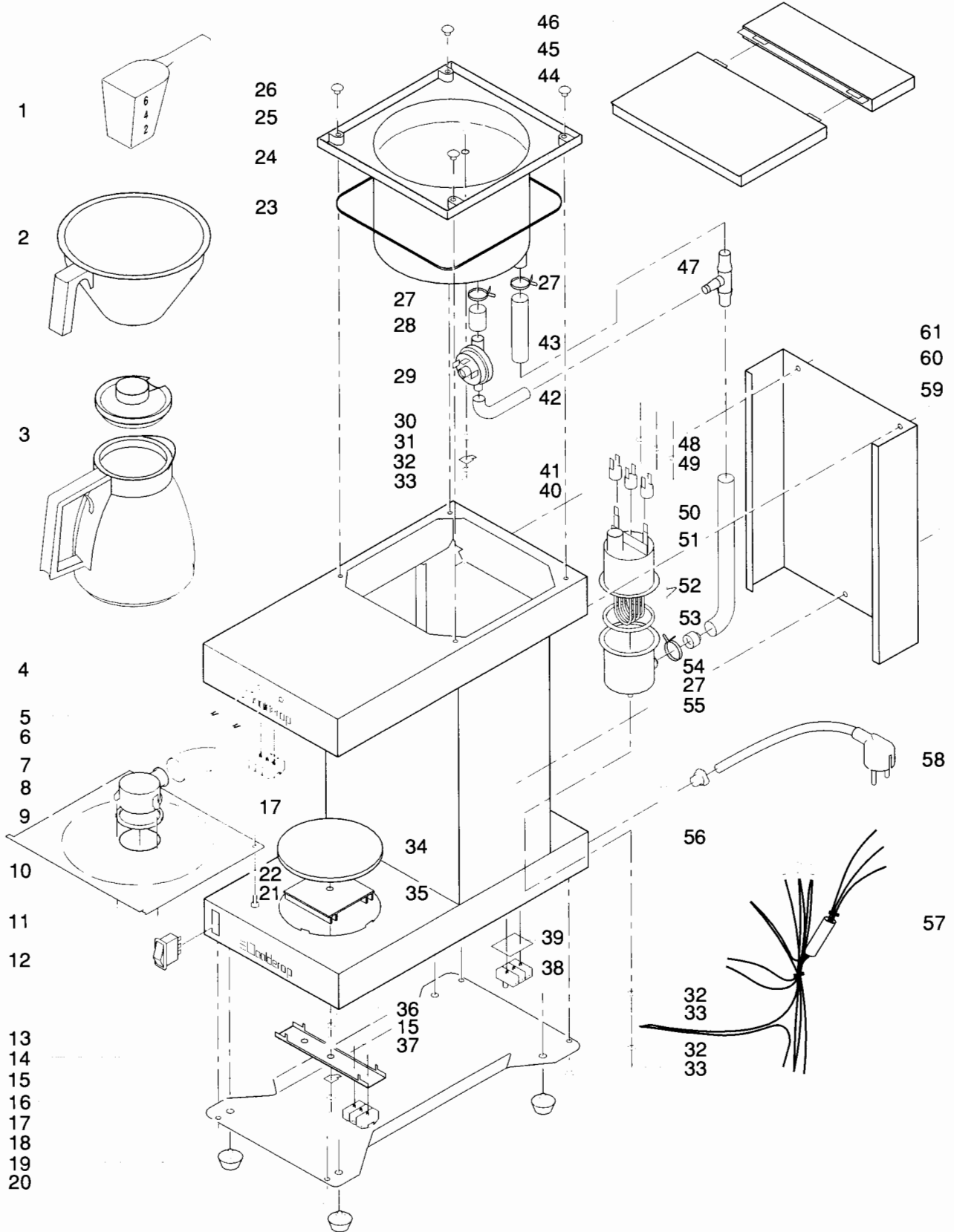

Pos.	No.	Description	Article No.	Pos.	No.	Description	Article No.
1	1	Measuring scoop	02.98.79.008	*33	4	Nut (M5)	02.98.82.056
2	1	Filter holder	02.98.10.011	34	1	Hotplate	02.90.44.098
3	1	Jug with cover	02.98.40.023	35	1	PTC-element	02.98.70.100
		Cover for jug	02.98.17.034	*36	1	Lock washer (4.4/12 mm)	02.98.82.060
4	1	Frame complete		37	1	Nut (M4x8)	02.98.82.062
5	1	Pilot light (orange)	67.72.01.002	38	1	Terminal block	68.31.31.003
6	1	Pilot light (red)	67.72.01.001	39	1	Terminal block plate	07.98.91.139
7	1	Hose from boiler to spray head	02.98.74.062	40	1	Thermostat with bracket	02.98.78.021
8	1	Spray head	02.98.22.015	41	2	Temperature protection with bracket	02.98.65.010
9	1	O-ring for spray head	02.98.83.074	42	1	Hose from prestostat to T-piece	02.98.74.065
10	1	Support plate for spray head	02.99.44.174	43	1	Hose from tank to T-piece	02.98.74.066
*11	3	Screw (No. 4x3/8")	02.98.82.031	44	1	O-ring (5x1.75 mm)	83.34.17.109
12	1	On/off switch (green)	68.78.26.909	*45	1	Screw (M5x20)	02.98.82.055
13	1	Bracket for hotplate	02.99.37.160	46	1	Cover complete	02.90.17.033
14	1	Earth connector (M4/4.8x0.8)	68.31.12.574	47	1	T-piece	02.98.46.013
*15	2	Spring washer (4.2 mm)	82.74.52.014	*48	3	Nut (M3)	82.48.03.112
*16	1	Nut (M4)	82.48.03.114	*49	3	Spring washer (3.2 mm)	82.74.53.012
17	2	Terminal block	68.31.31.014	50	1	Hose from T-piece to boiler	02.98.74.064
*18	4	Screw with spring washer (No. 6x3/8")	02.98.82.022	51	1	Boiler head with element Boiler complete with pos. 51, 52, 53 and 55	02.90.40.094 02.90.70.045
19	4	Foot for base plate	02.98.11.025	52	3	Clamping spring for boiler	02.98.77.027
20	1	Base plate	02.99.39.143	53	1	O-ring for boiler	83.34.32.060
*21	2	Screw (M4x8)	82.02.05.093	54	1	Non-return valve complete	02.90.65.004
*22	2	Spring washer (4.3 mm)	82.74.59.013	55	1	Boiler foot	02.90.40.093
23	1	Seal for tank	02.98.13.038	56	1	Cable coupling	68.36.35.308
24	1	Tank	02.98.05.008	57	1	Wire tree with connectors	02.98.66.180
*25	4	Screw (No. 6x3/8")	02.98.82.071	58	1	Mains plug with flex-cord	02.98.68.038
26	4	Screw cap for tank	02.98.15.038	59	1	Backplate	02.99.22.034
27	3	Hose clip	74.47.72.720	*60	3	Screw with spring washer (M4x12)	82.08.93.047
28	1	Hose from tank to prestostat	02.98.74.067	*61	4	Spacer ring (M4x2)	82.73.30.013
29	1	Prestostat	64.06.01.024				
*30	1	Lock washer (5.3 mm)	82.74.07.114				
31	1	Earth connector (M5/6.3x0.8)	68.31.12.828				
*32	3	Spring washer (5.2 mm)	82.74.51.015				

\* Standard stock items in trade distribution outlets

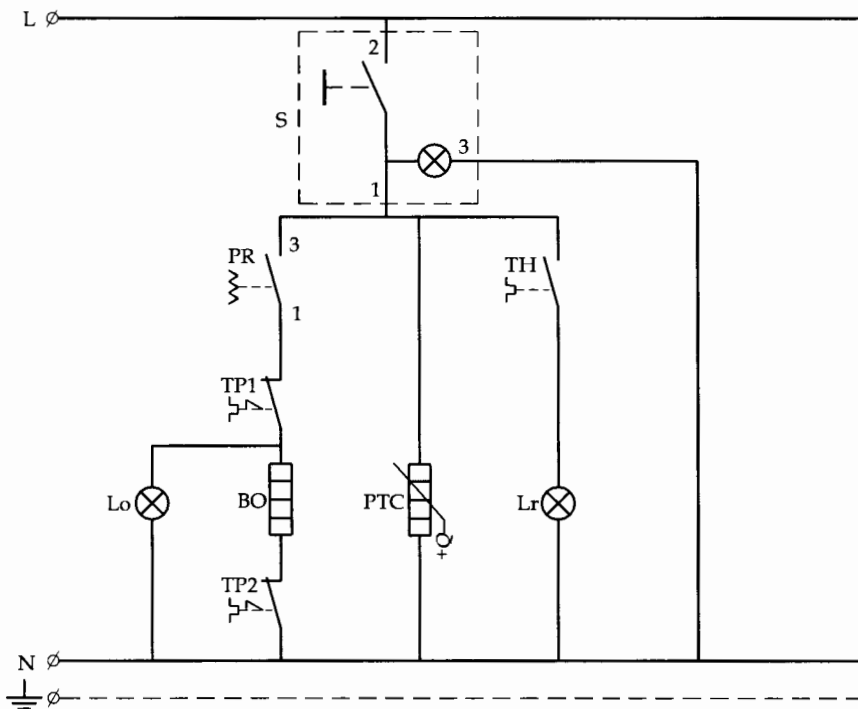

Electrical Diagram

- b = black
- bl = blue
- br = brown
- gy = green/yellow
- r = red
- w = white
- y = yellow

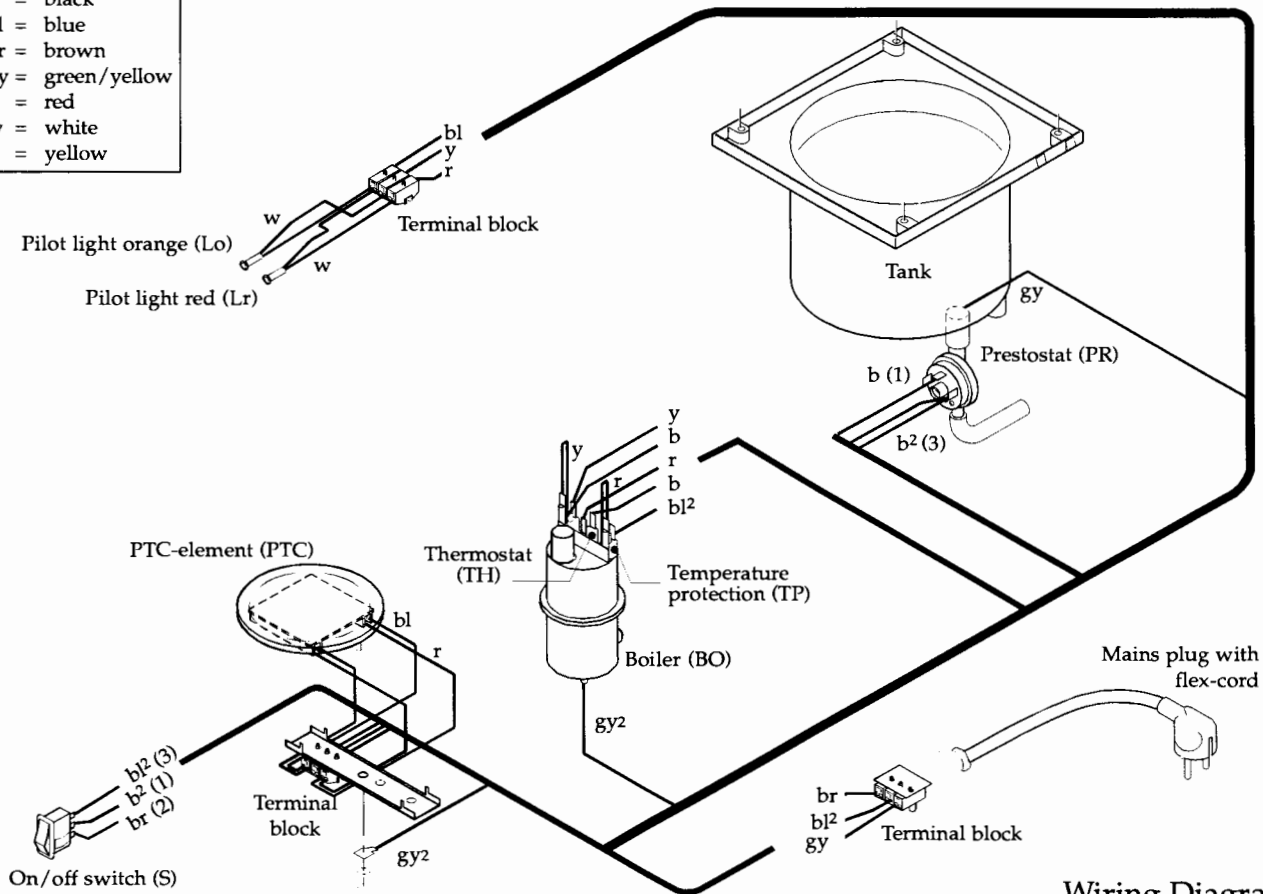

Wiring Diagram  
www.daalderop.se